

**ALLDAY
& MILLER**



West Mead, Ruislip, HA4 0TL
£4,000 Per Month

5 2 2



West Mead, Ruislip, HA4 0TL

£4,000 Per Month

- Fully Renovated to an Exceptional Modern Standard
- Five Bedrooms Including Impressive Top-Floor Suite
- Separate Reception Room
- Utility Room With Ample Storage
- Large Garden Ideal For Outdoor Living
- Stunning Open-Plan Kitchen / Dining / Living Space
- Two Contemporary Bathrooms Plus Ground-Floor WC
- Ground Floor Home Office
- Prime Ruislip Location
- finished With Style and Luxury

Description

Presented in immaculate condition throughout, this beautifully redesigned five bedroom home offers exceptional living space, luxury finishes, and contemporary comfort across three thoughtfully planned floors. Every detail has been crafted to a high modern standard, creating a warm, stylish, and functional family home.

Situation

West Mead is a peaceful residential pocket highly sought after by families for its excellent amenities and community feel. The area is served by outstanding local schools including Whiteheath Infant & Junior, Ruislip High and Bishop Ramsey. Transport links are exceptional, with Ruislip and Ruislip Manor stations offering Metropolitan and Piccadilly line services for fast access into Central London, while nearby West Ruislip provides Central Line and Chiltern Railways connections.

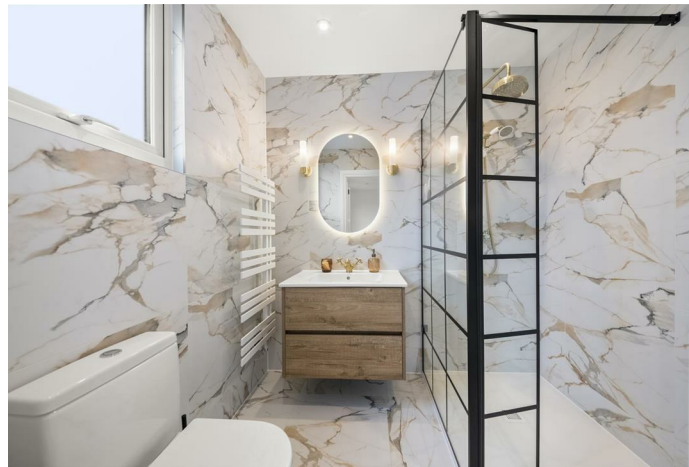

Floor Plans

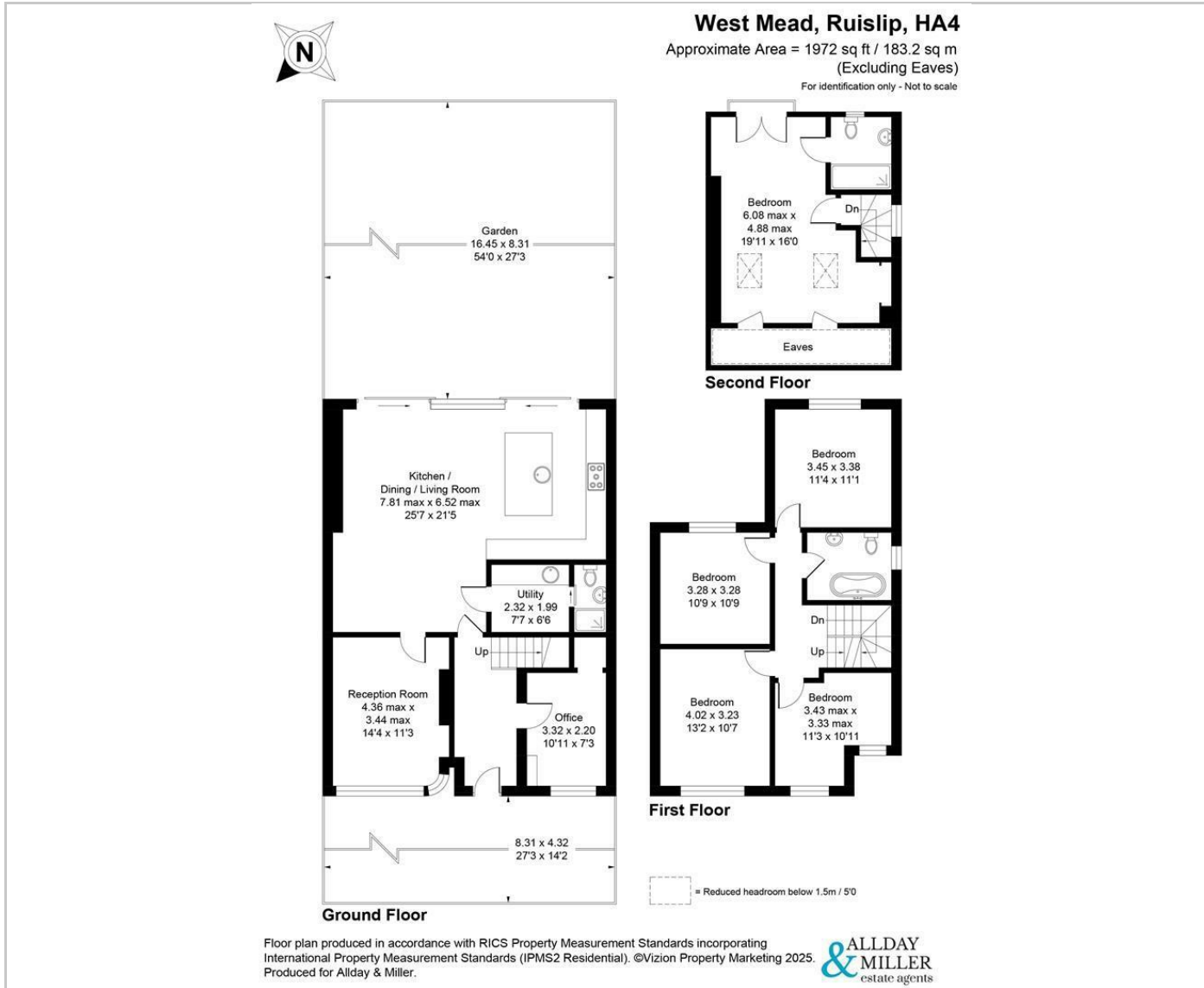

Area Map

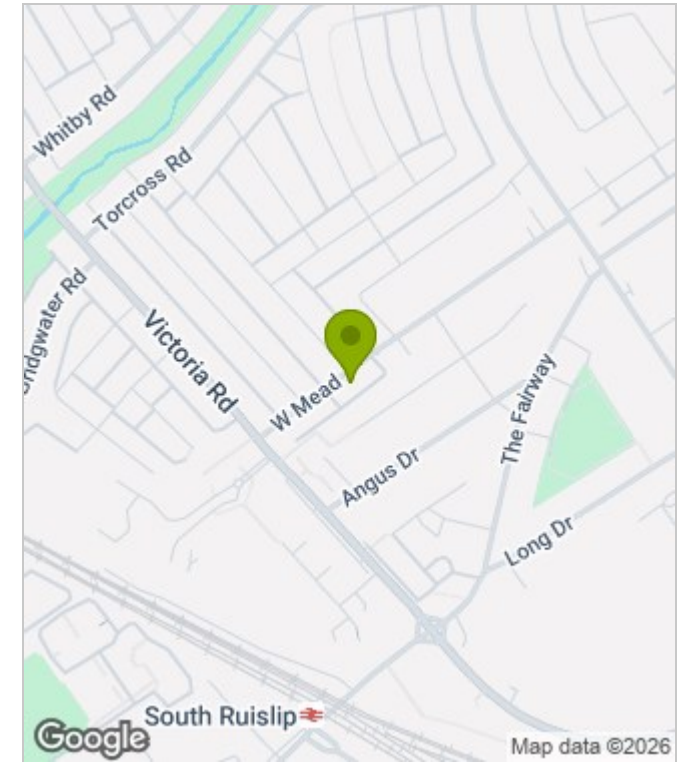

Energy Performance Graph



These particulars, whilst believed to be accurate are set out as a general outline only for guidance and do not constitute any part of an offer or contract. Intending purchasers should not rely on them as statements of representation of fact, but must satisfy themselves by inspection or otherwise as to their accuracy. No person in this firm's employment has the authority to make or give any representation or warranty in respect of the property.